

Inquadramento generale
Indicazione dell'ubicazione della casa in riferimento alla planimetria generale

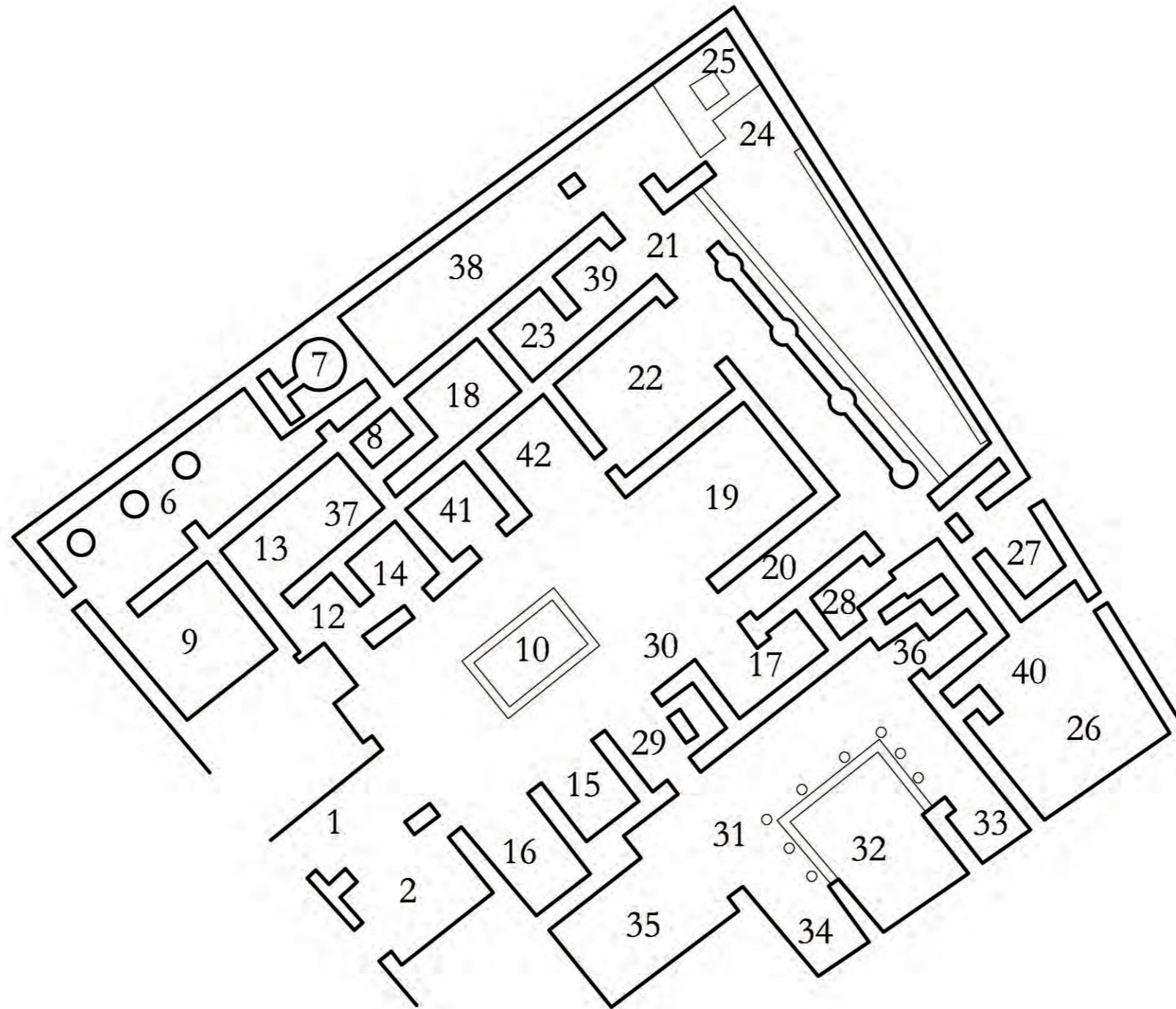

Inquadramento generale
Indicazione degli ambienti oggetto di rilievo grafico



Rilievo delle pareti
Ambiente 25 - parete NN

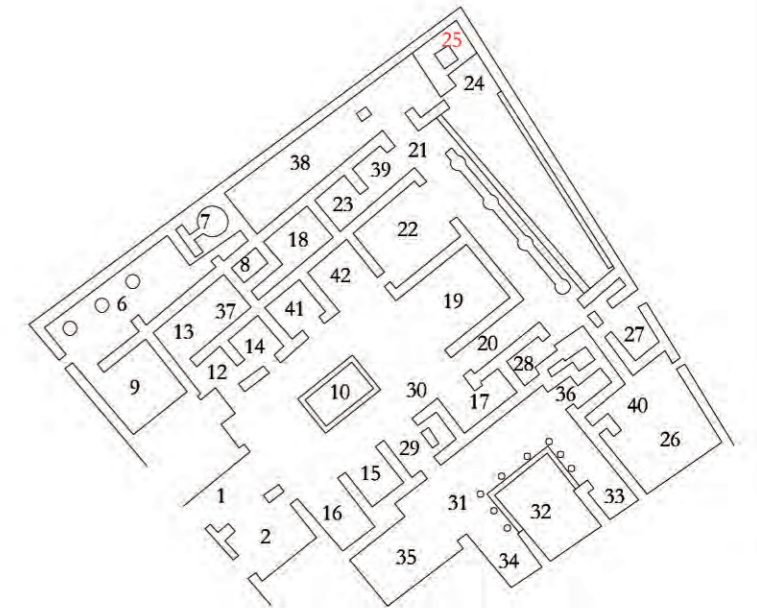

Schema planimetrico
(fuori scala)

TAV. 02

scala grafica

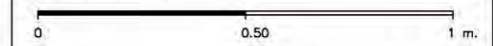

DATA:
settembre 2010

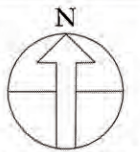

orientamento dello
schema planimetrico

Rilievo del pavimento
Ambiente 25 - parete NN

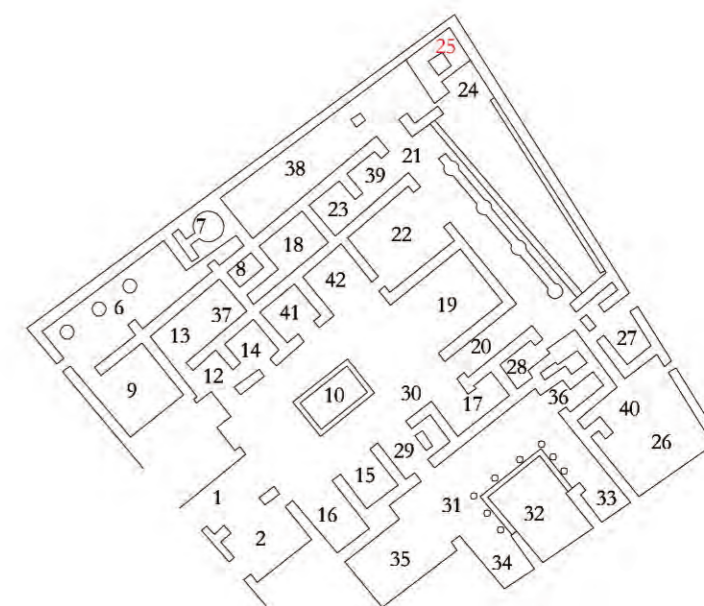
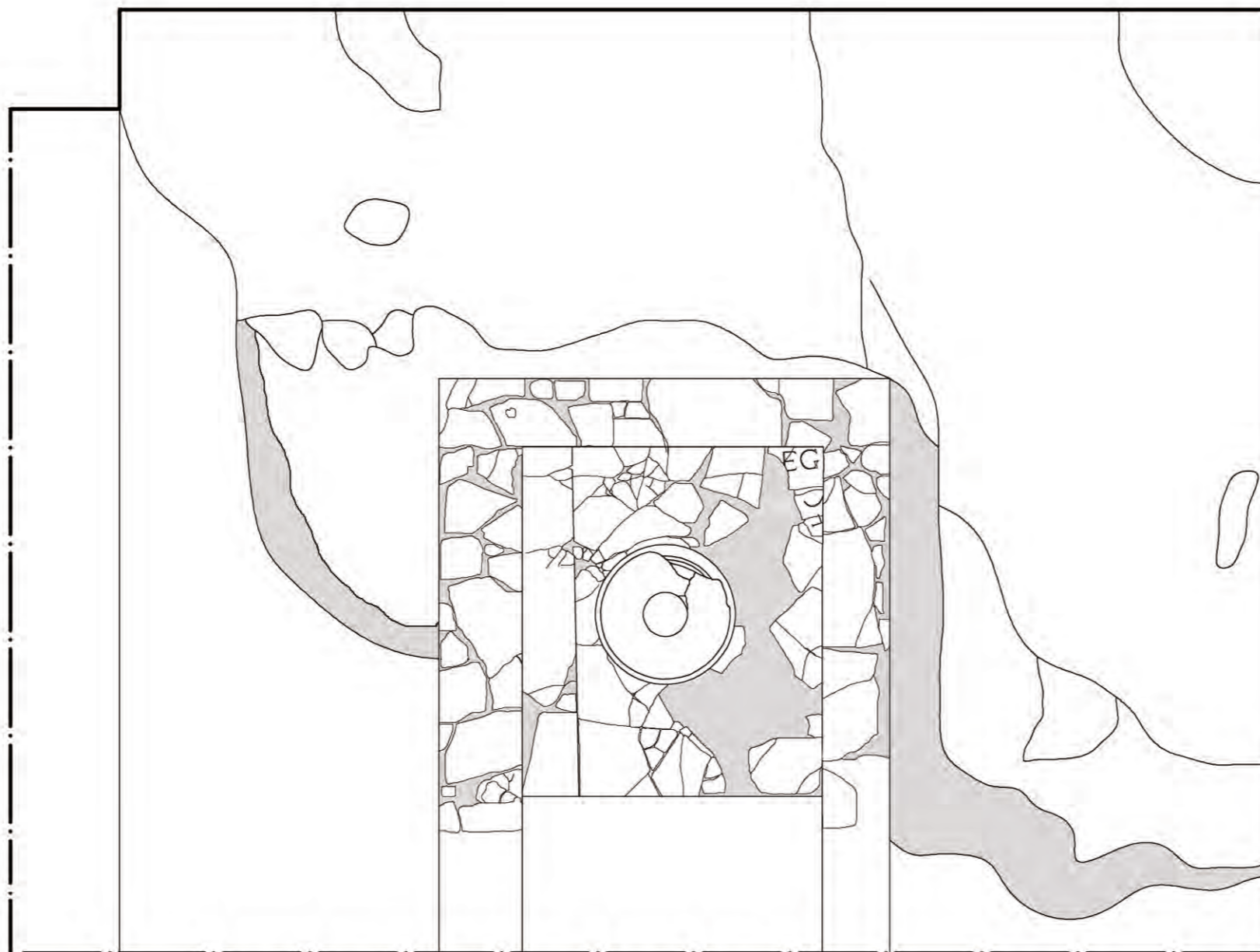

Schema planimetrico
(fuori scala)

TAV. 03

scala grafica

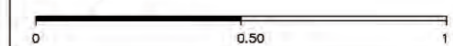

DATA:
settembre 2010

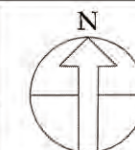

orientamento dello
schema planimetrico

Rilievo delle pareti
Ambiente 25/24 - parete NN

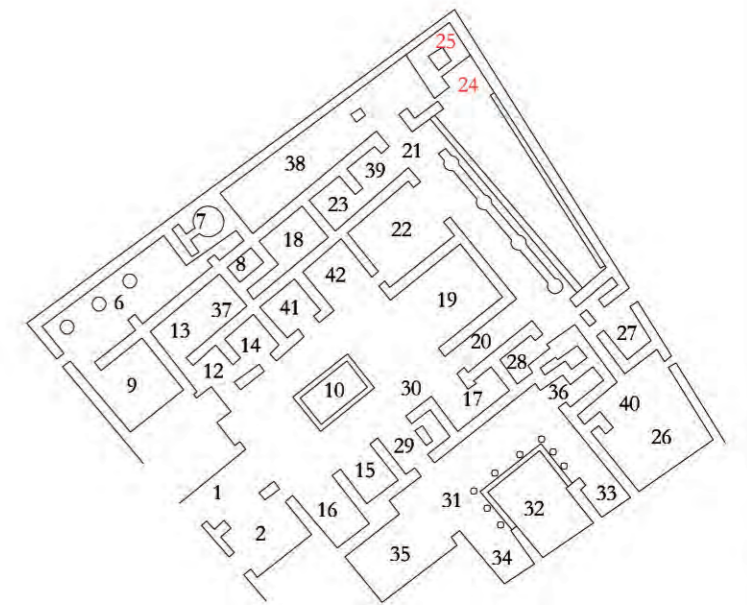
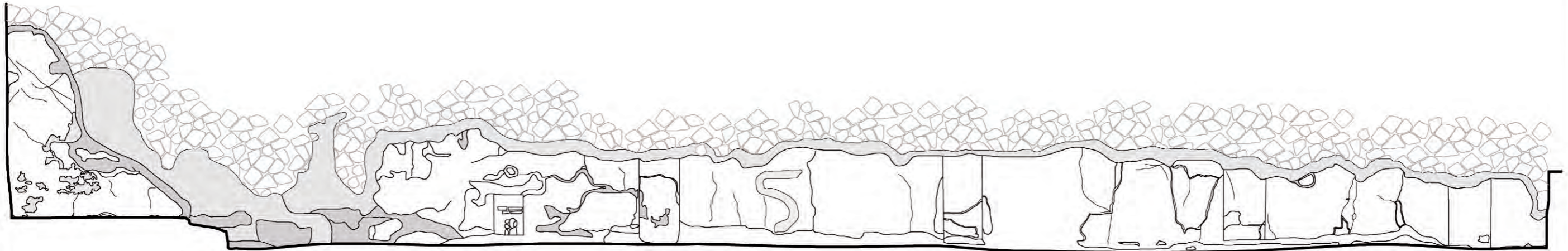

Schema planimetrico
(fuori scala)

TAV. 04

scala grafica



DATA:
settembre 2010

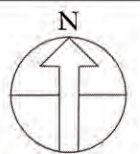

orientamento dello
schema planimetrico

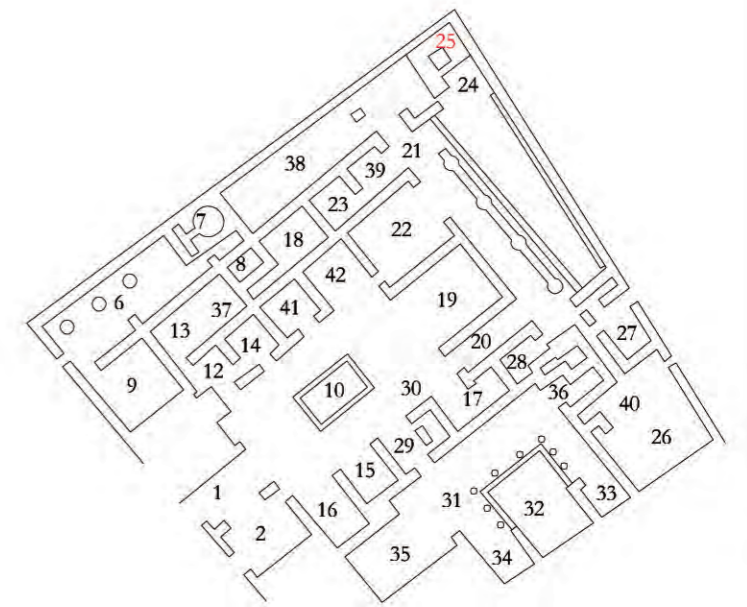
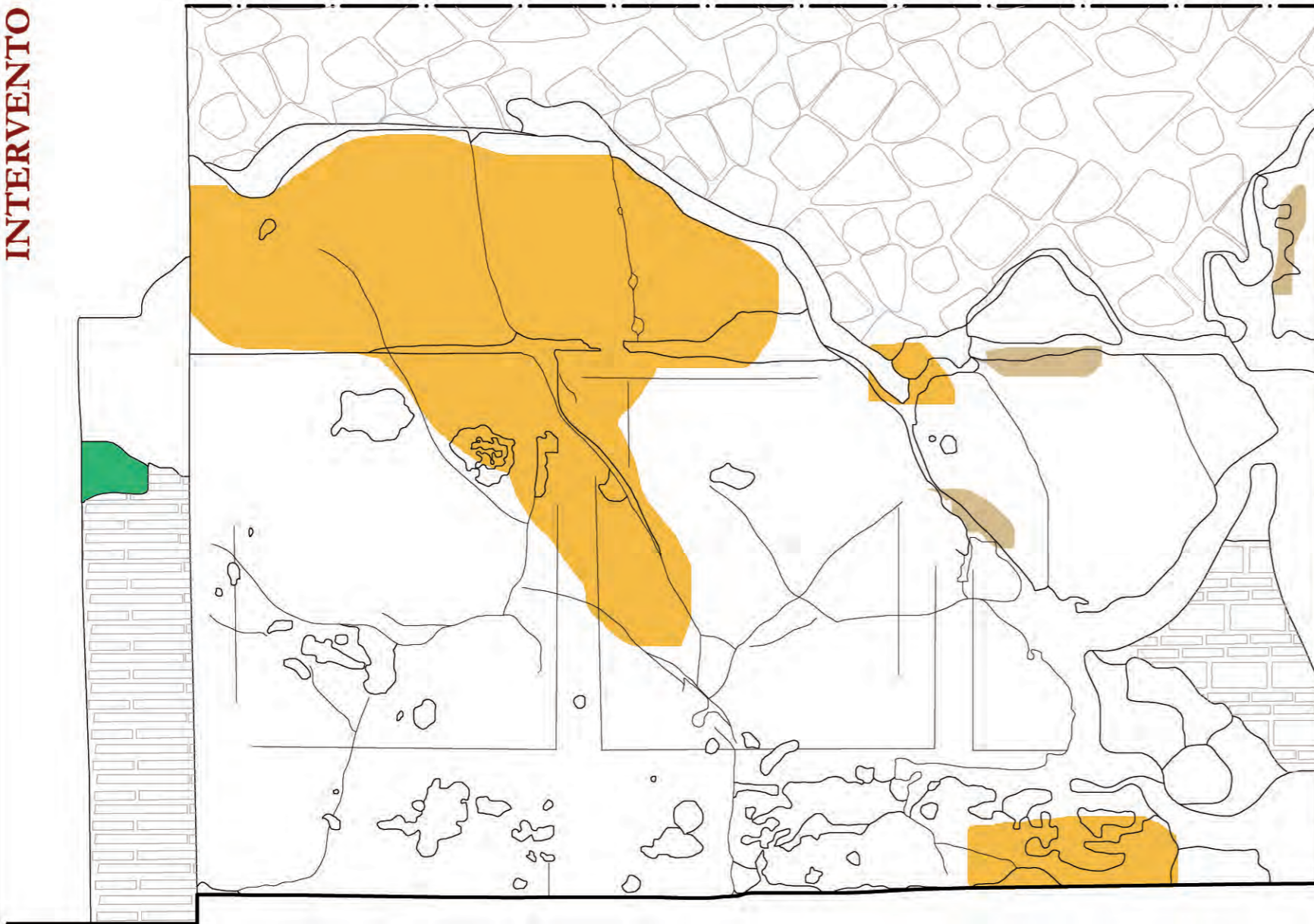

Rilievo delle pareti
Ambiente 25 - parete NN



Schema planimetrico
(fuori scala)

TAV. 05

LEGENDA

-  consolidamento delle disgregazioni dell'intonaco con resina acrilica a bassa concentrazione
-  ricollocazione frammento originale
-  consolidamento supporto murario, intonaco e intonachino (002)

scala grafica

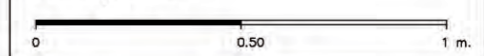

DATA:
settembre 2010

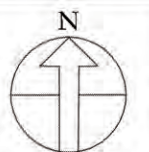

orientamento dello
schema planimetrico

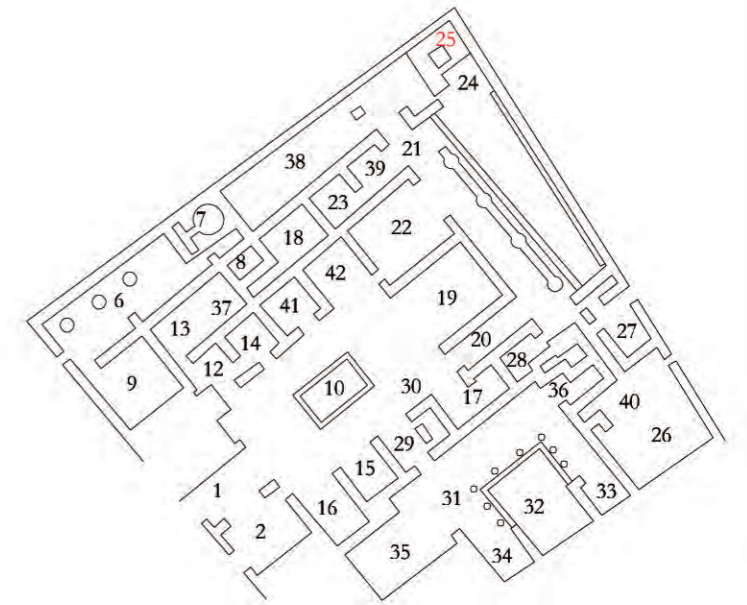
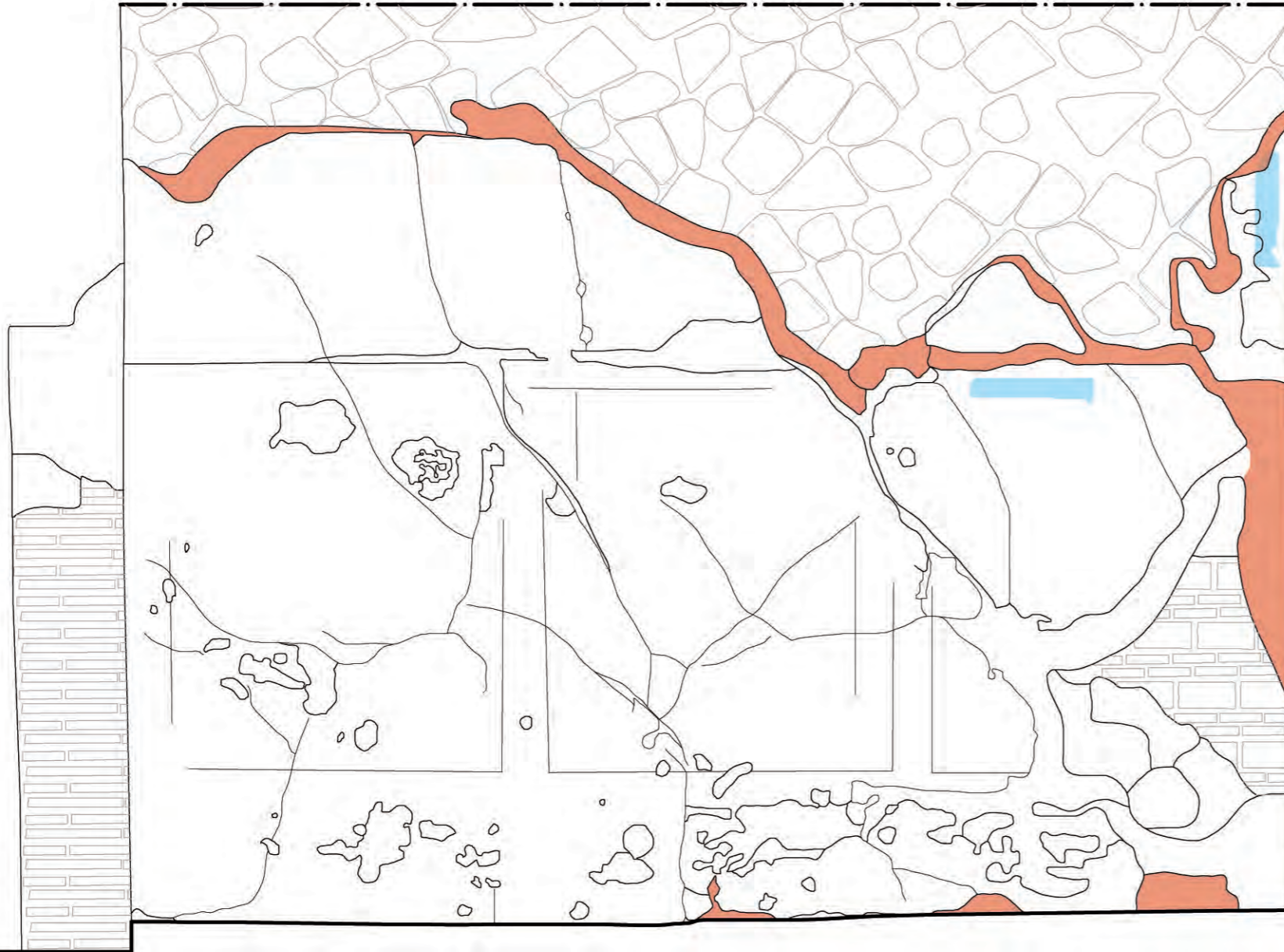

Rilievo delle pareti
Ambiente 25 - parete NN



Schema planimetrico
(fuori scala)

TAV. 06

LEGENDA

-  stuccatura sottolivello
-  stuccatura bordi intonaco con malta

scala grafica

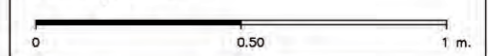

DATA:
settembre 2010

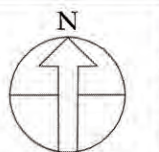

orientamento dello
schema planimetrico

Rilievo delle pareti
Ambiente 25/24 - parete NN

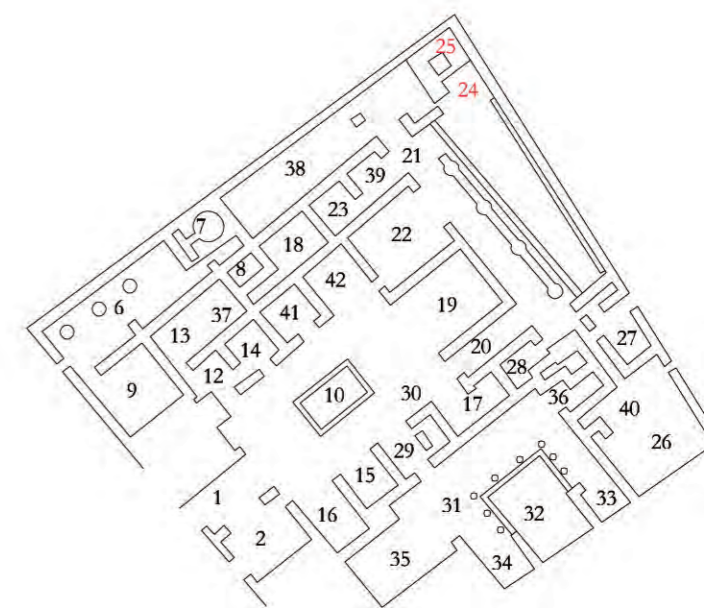
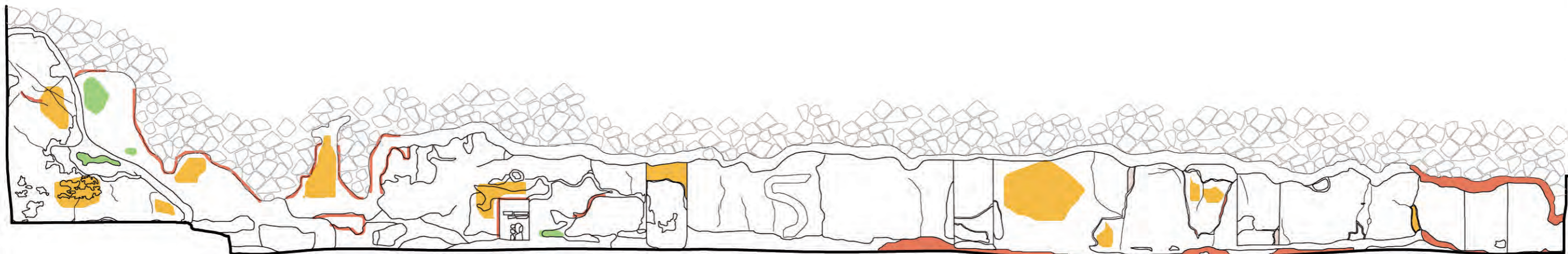

INTERVENTO DI RESTAURO

TAV. 07

LEGENDA



consolidamento supporto murario ,
intonaco e intonachino (002)

stuccature sottolivello



stuccatura bordi intonaco con malta

scala grafica



DATA:
settembre 2010

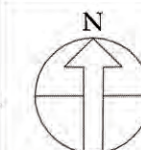

orientamento dello
schema planimetrico

Rilievo del pavimento
Ambiente 25 - parete NN

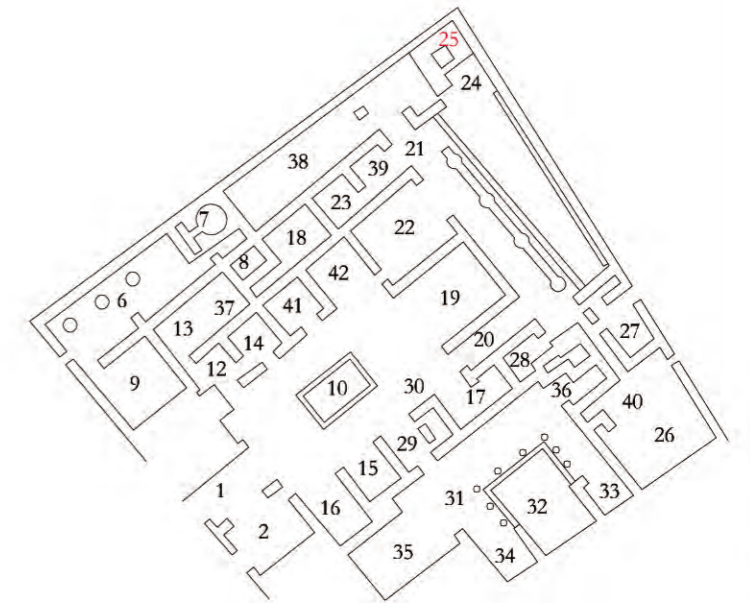
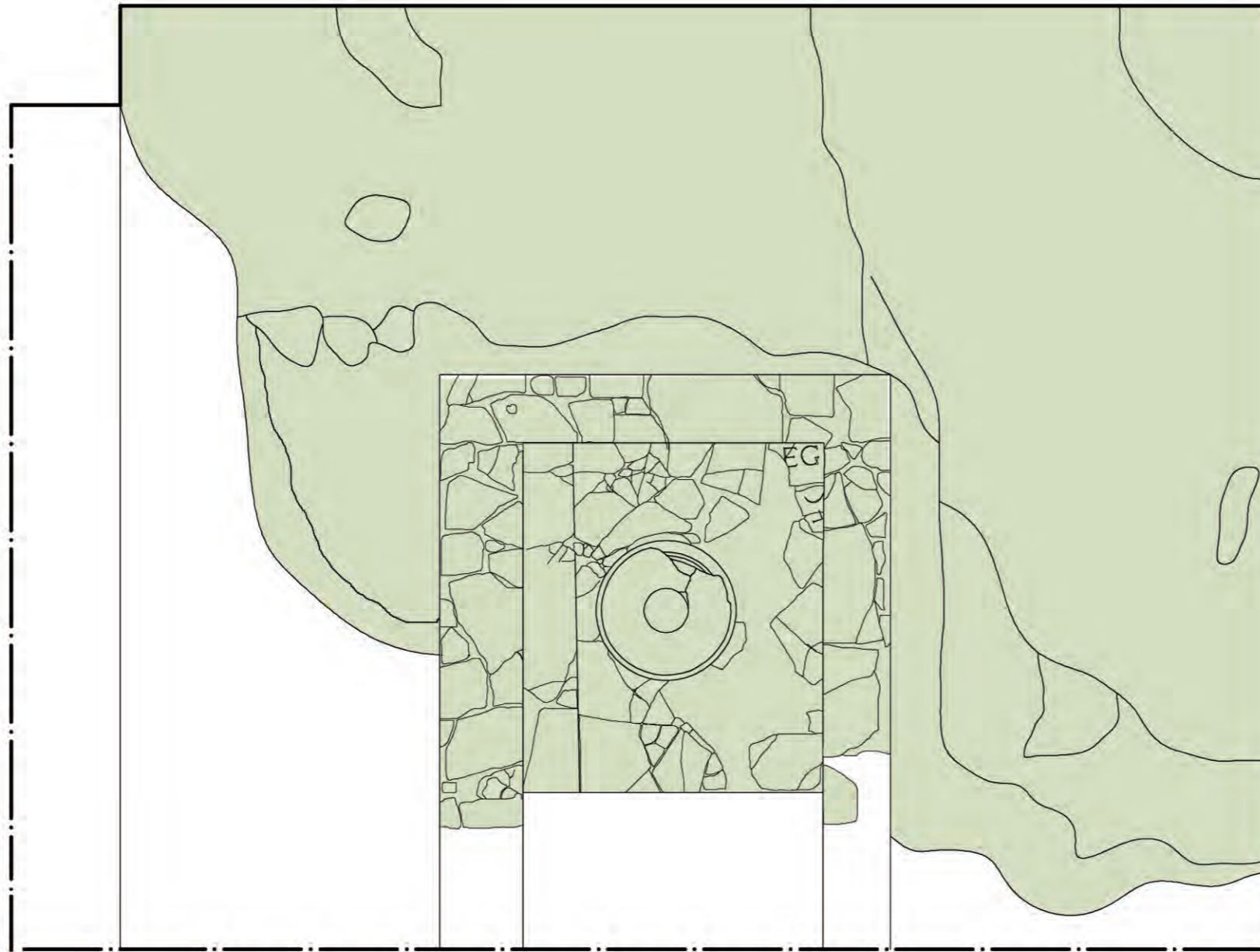

Schema planimetrico
(fuori scala)

TAV. 08

LEGENDA



disinfestazione pavimento con biocida

scala grafica

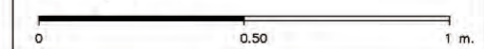

DATA:
settembre 2010



orientamento dello
schema planimetrico

Rilievo del pavimento
Ambiente 25 - parete NN

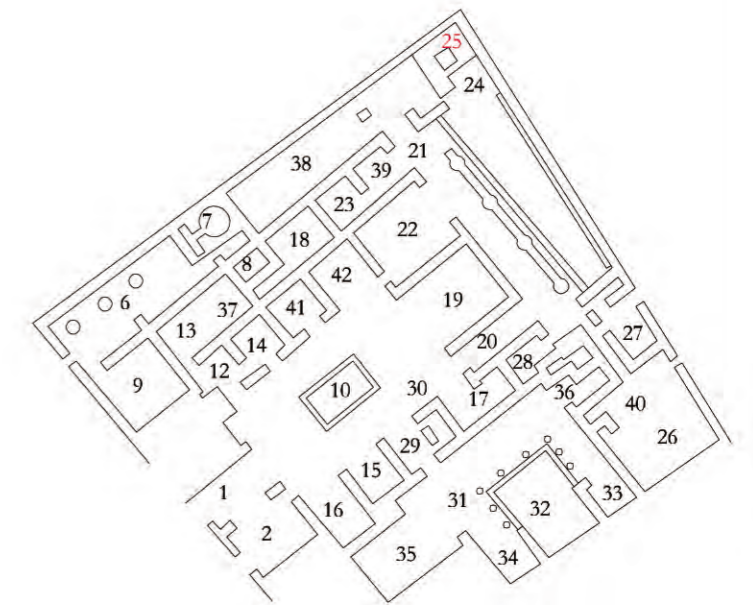
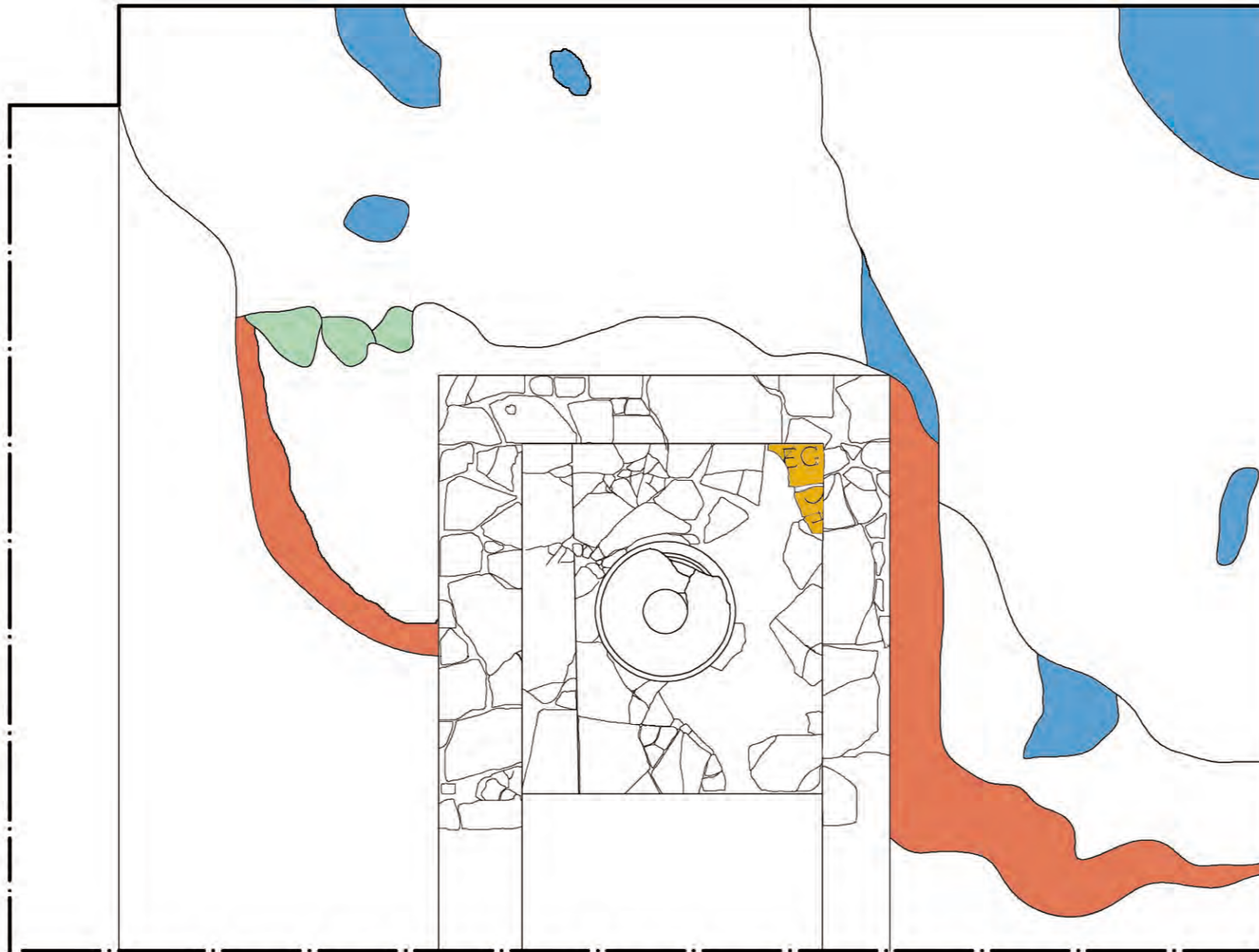

Schema planimetrico
(fuori scala)

TAV. 09

LEGENDA

- | | | | |
|---|----------------------------|---|---------------------------------|
|  | stuccatura bordi pavimento |  | consolidamento tessere di marmo |
|  | frammenti ricollocati |  | stuccature del pavimento |

scala grafica

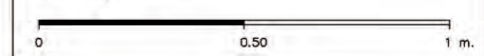

DATA:
settembre 2010



orientamento dello
schema planimetrico